

# Measuring for your **single ended** angled wardrobe

## Dimensions

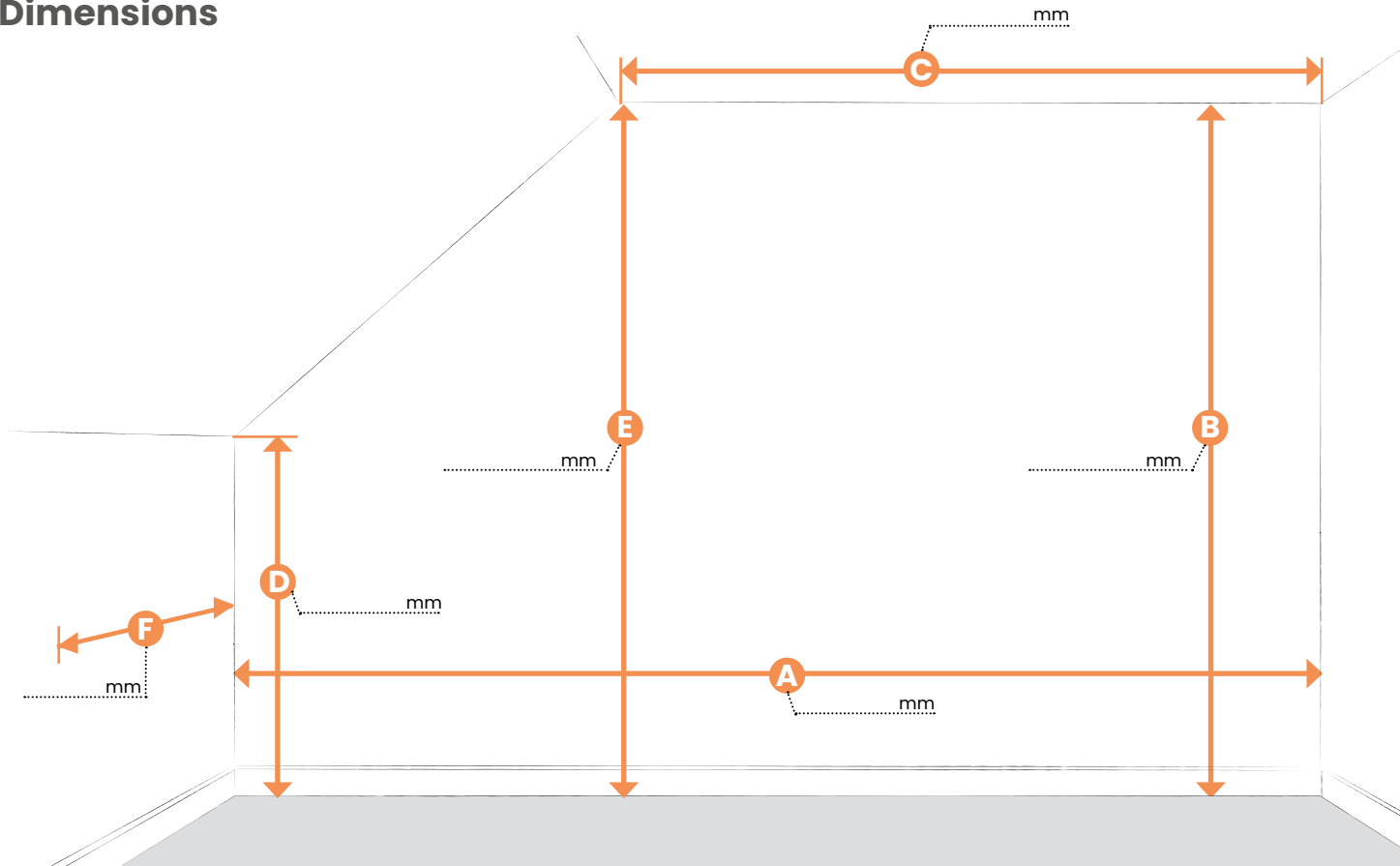

## Using a tape measure



- A** Measure the **full width**, at floor level, from one wall to the other.
  - B** Measure the **full height** from floor to ceiling.
  - C** Measure the **ceiling width** from the wall to the start of the angled slope.
  - D** Measure the **wall height** from the floor to the start of the angled slope.
- Measure the Height at the start of the angled slope.**
- F** Measure the **Depth of the wardrobe**. We recommend a minimum of 620mm if you want hanging rails.

**Important:** remember to measure roughly in the position of where the doors will be, rather than flat to the back wall. This is in case the walls bow or taper.

## YOUR MEASUREMENTS

**A** \_\_\_\_\_ mm   **B** \_\_\_\_\_ mm   **C** \_\_\_\_\_ mm   **D** \_\_\_\_\_ mm   **E** \_\_\_\_\_ mm   **F** \_\_\_\_\_ mm

# Designing your fitted wardrobe (end to end)

Draw your wall as a rectangle on a sheet of paper

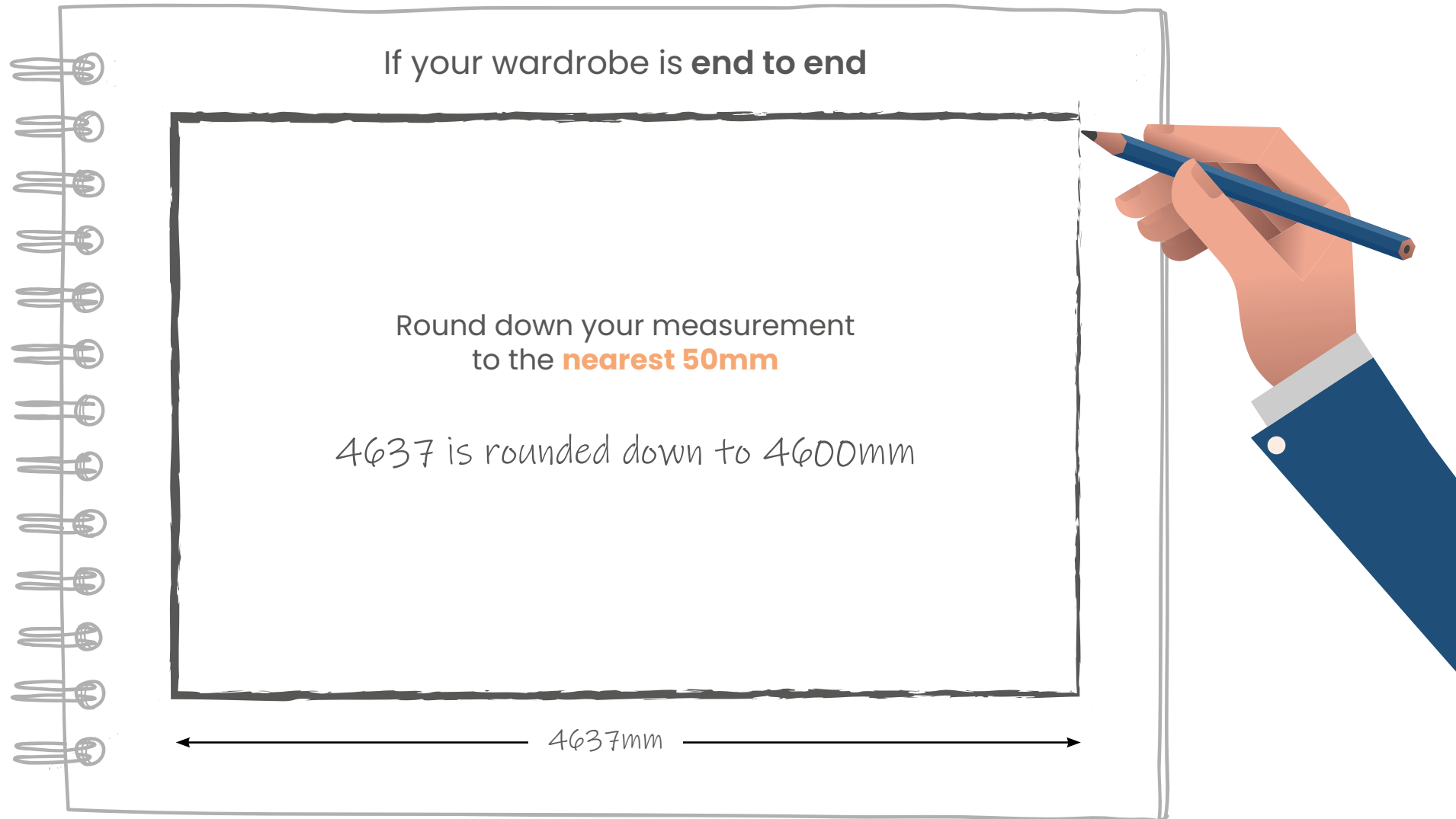

# Designing your fitted wardrobe (end to end)

## Include the side scribe panels

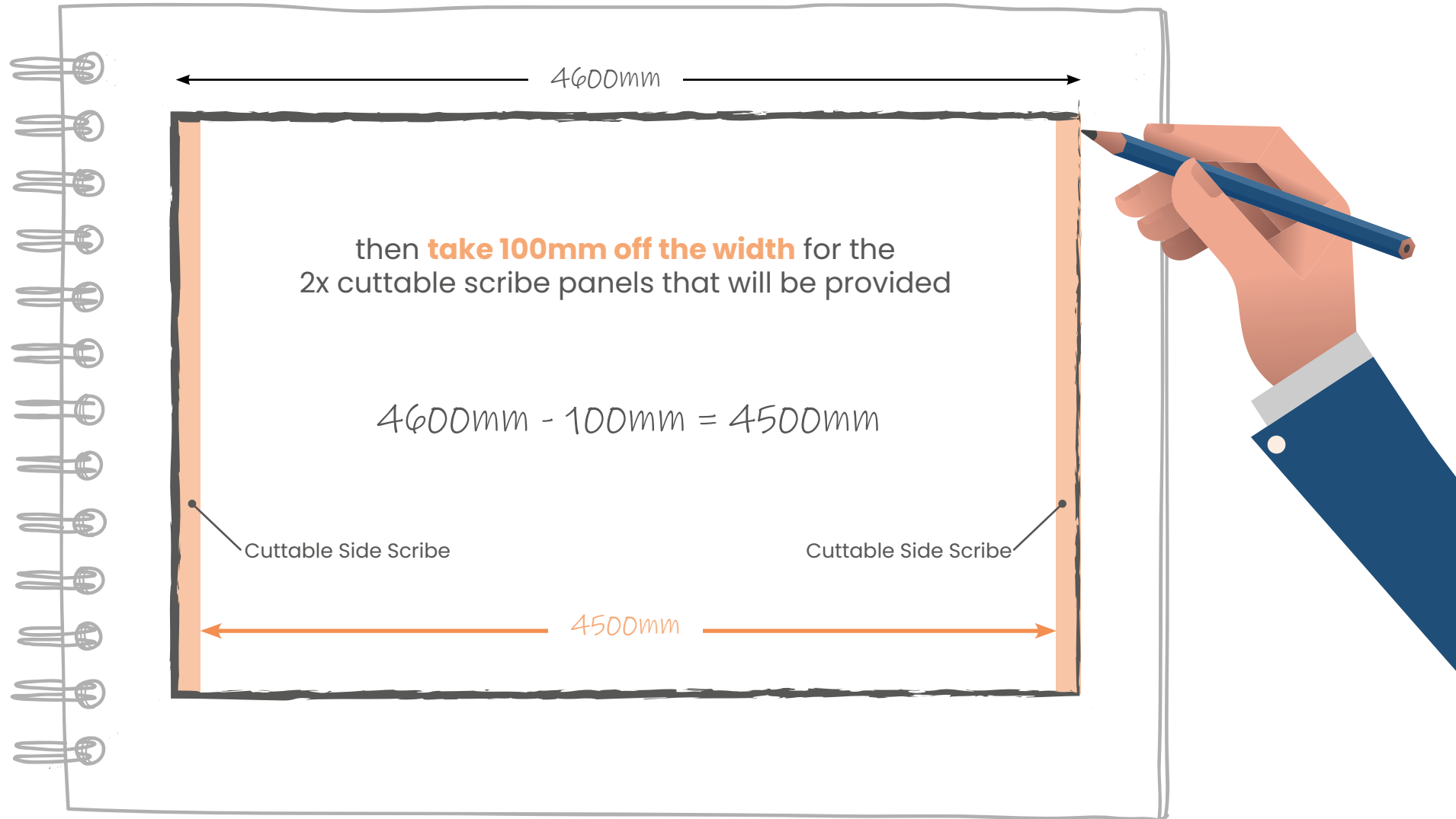

# Designing your fitted wardrobe (one open end)

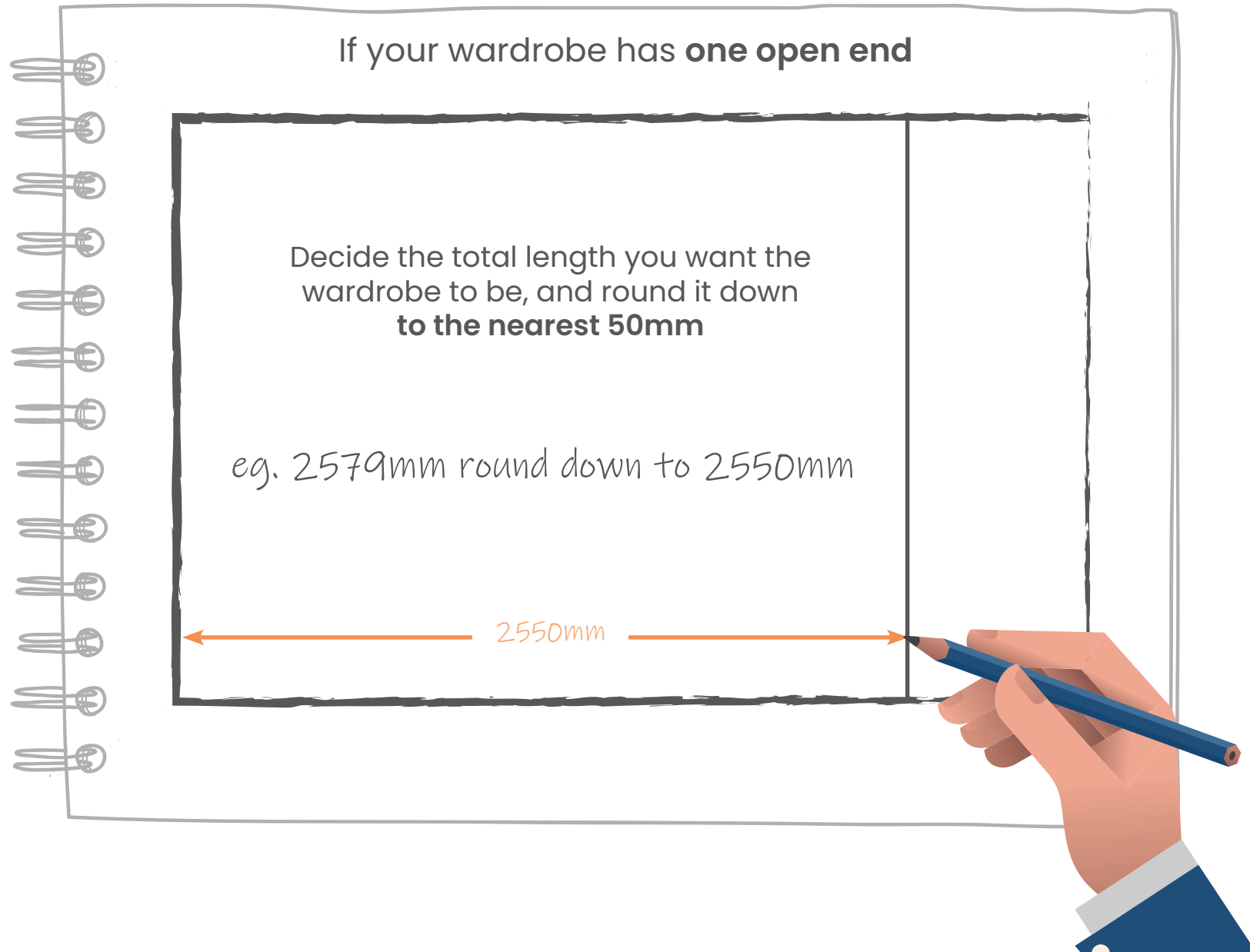

# Designing your fitted wardrobe (one open end)

## Include the side scribe and end panels

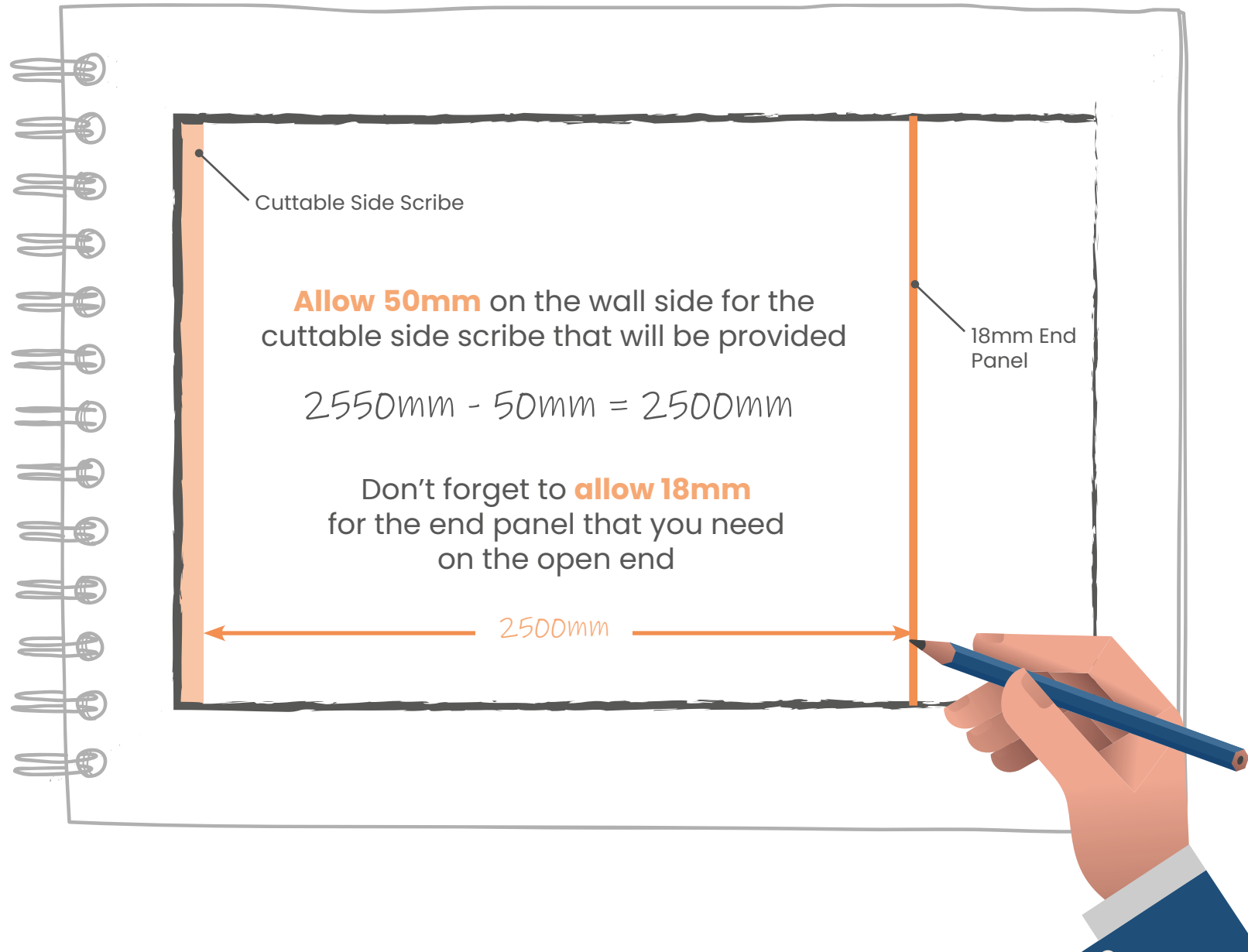

# Designing your fitted wardrobe (Internal Options)

Choose from our range of [internal option modules](#) and work out what you want to go in each section

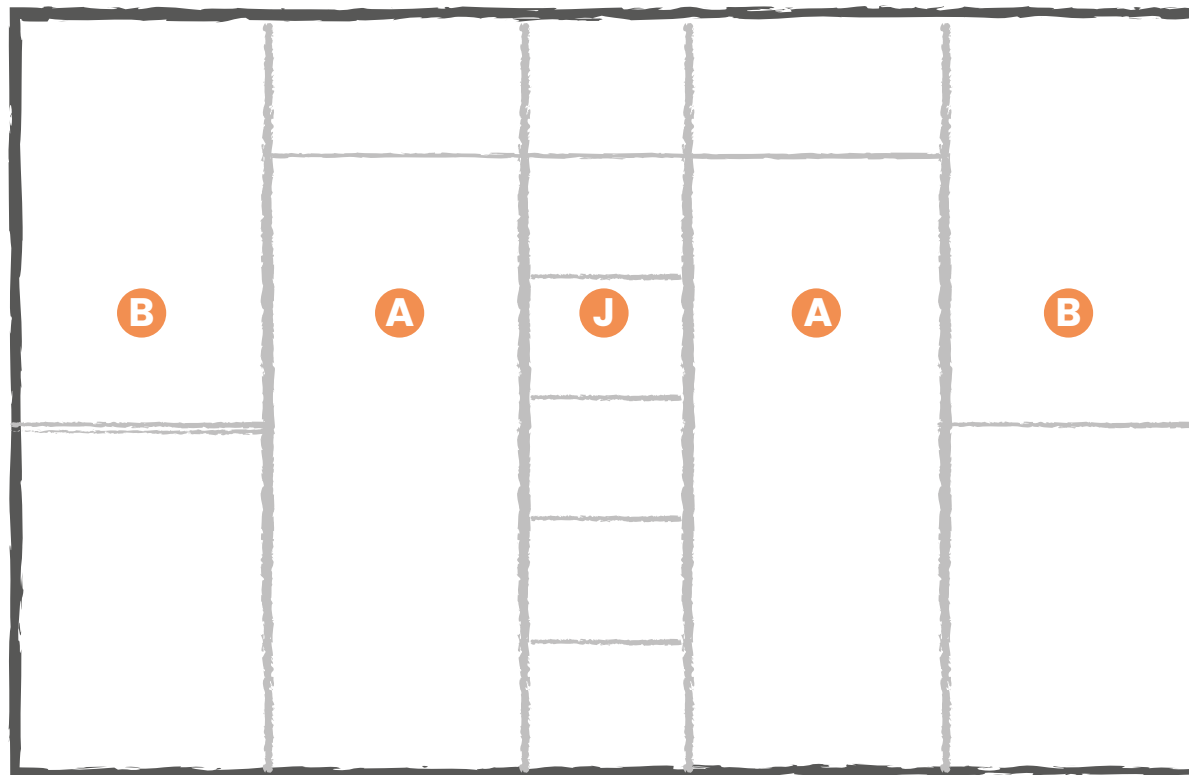

2327mm

4500mm

# Need more help?



If you have read this document and still need more help, contact us through our website



[www.online-bedrooms.co.uk](http://www.online-bedrooms.co.uk)

or by phone.



0115 718 0322



One of our friendly, expert wardrobe designers are there to help plan your dream fitted bedroom.



We're with you, helping every step of the way, so you can be enjoying your new wardrobes in no time!



**Planning grid**

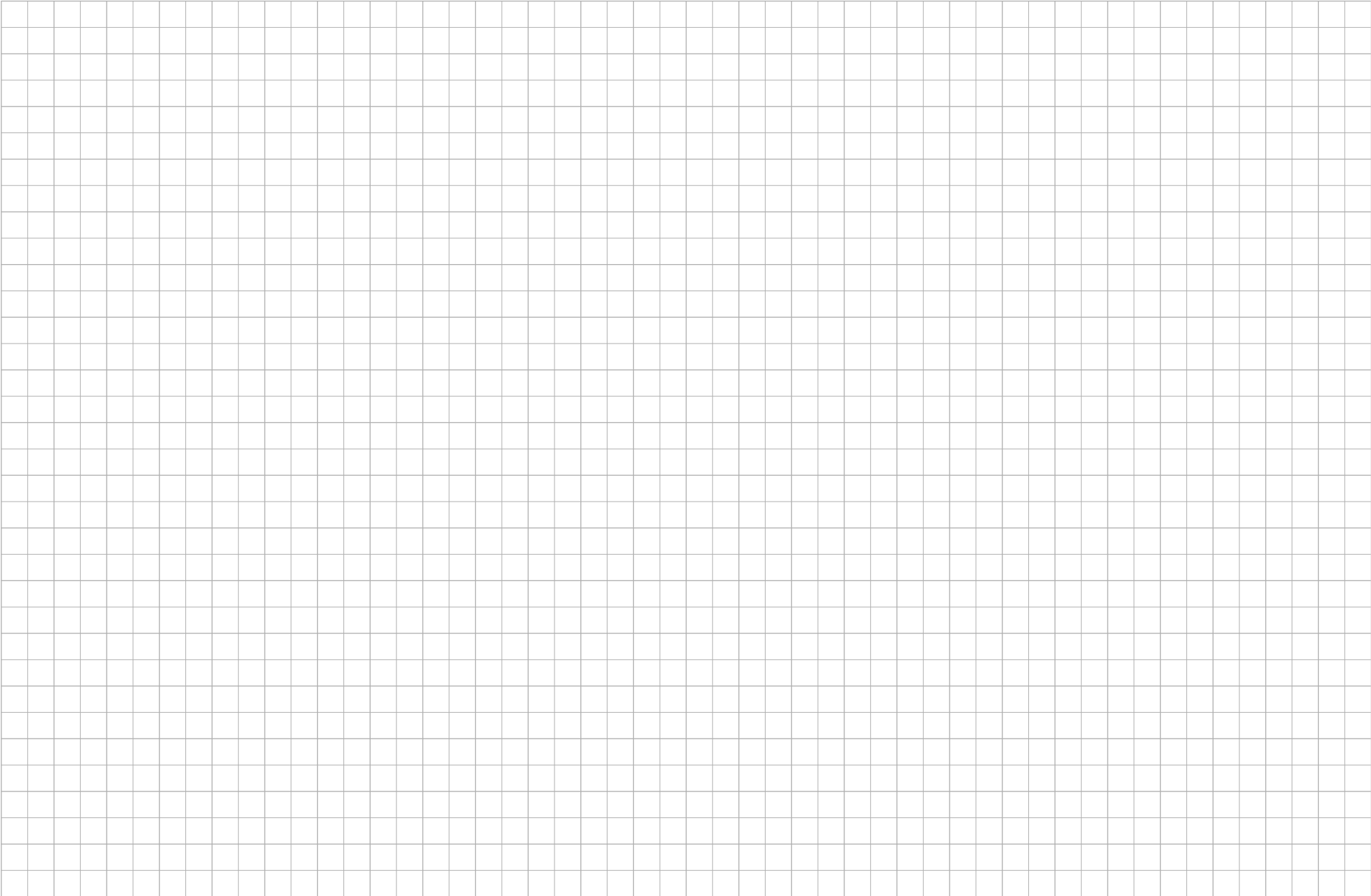

← → SCALE 1:200 (1 SQUARE ON GRID = 200MM)





[www.online-bedrooms.co.uk](http://www.online-bedrooms.co.uk)